

EXTERNAL ANGLES

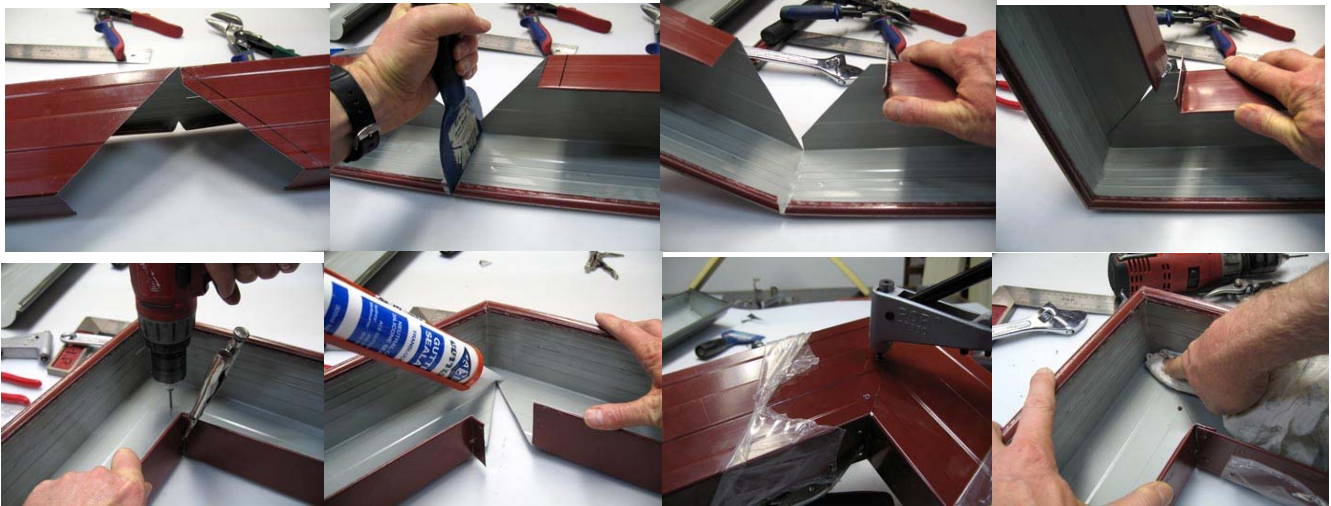

Determine your starting point from a corner and then drive a nail or screw into the fascia.

Use this as a starting point for a string line then at the opposite end of the gutter fix another nail or screw with the fall towards your downpipe outlets.

Recommended fall 1:500mm.

Please see the illustrations for the CUTTING OF ANGLES

BRACKETS

When installing Ace Square-line there are two types of bracketing systems that you can choose from:

- (i) a *concealed bracket* is the most commonly used bracket, spaced at 1.0m intervals.

Fix metal or timber suspension clips at approximately 1m centres on top of the fascia (checking the level of the fascia) slide back edge of gutter up into the adjusting teeth, falling towards the downpipe at 1:500mm.

The use of suspension clips is highly recommended if you are working alone.

Insert your concealed brackets fixing the brackets by either nailing or screwing through the bracket and gutter into the fascia.

- (ii) another popular bracketing system used in conjunction with our metal or timber suspension clip is the “overstrap” bracketing system.

With the suspension clips fitted at 1.0m intervals (by snapping the clip over the top of the steel fascia and then applying pressure down with heel of the palm and into place).

Having placed your overstrap brackets at 1.0m centres into the gutter whilst the gutter is on the ground you then lift the gutter up into the suspension clip engaging the back edge of the gutter into the suspension clip (adjust fall) then fold the strap over the top of the timber.

HOW TO FIT A NOZZLE

Place your nozzle on the bottom of the gutter and mark around the inside of the nozzle with a marker, at the same time marking your rivet holes, then cut out the marked area using snips, drilling 1/8th holes for the rivets (the cut out for 90mm is 96mm x 63mm).

Apply approximately a 6mm strip of Ace Neutral Cure Sealer around the flanges of the nozzle and place the nozzle over the cut out section and then fixing the nozzle to the gutter using pop rivets. Clean off any excess sealer with a cloth.

STOP ENDS



When fitting stop end plates insert your stop end into the end of the gutter, then drill 4 holes, two into the back of the gutter, one into the bottom of the gutter and one into the front of the gutter, then separate the stop end from the gutter, apply sealer around the end of the gutter and then re insert the stop end plates. Fix by inserting pop rivets through the four pre drilled holes. Clean of any excess sealer with a cloth.

SEALING OF ANGLES/NOZZLES/JOINS

When applying Ace Neutral Cure Sealer apply approximately a 6mm in diameter continuous seal along all joins. Always clean away excess sealer with a cloth.

Please Note – for your gutter system to work effectively please refer to the section below headed “Design, Installation and Maintenance Considerations”.

DESIGN, INSTALLATION and MAINTENANCE CONSIDERATIONS

DESIGN - for a gutter system to work effectively the roof drainage system must be designed by a suitably qualified trade professional, in accordance with the Building Code of Australia and Australian Standards.

When designing a gutter system the architect and or relevant qualified trade professional must give consideration to – rainfall intensity, roof mass / catchment area and gutter, downpipe sizes and number of downpipes required based on these considerations

INSTALLATION – a gutter system must be installed in accordance with the Acceptable Construction Manual AS/NZS 3500.3 Stormwater Drainage and or AS/NZS 3500.5 Domestic Installation, Stormwater Drainage.

Product Compatibility - please note there are some products that are not compatible with pre painted steel, for example lead and copper. Please refer to page 40 of our current price list for further information.

MAINTENANCE – it is important that once a gutter system has been installed a maintenance programme is put in place by the home owner / occupier to ensure that there are no blockages in the gutter system through the build up of debris or similar.



ACE GUTTERS PTY LTD ABN 49 001 885 276

SYDNEY
69 Boundary Road
Mortdale NSW 2223
Ph: 02 9584 4777
Fax: 02 9584 4799

MELBOURNE
12-14 Industrial Drive
Braeside VIC 3195
Ph: 03 9586 4888
Fax: 03 9586 4877

www.acegutters.com.au